

2024 REGION VI CONFERENCE

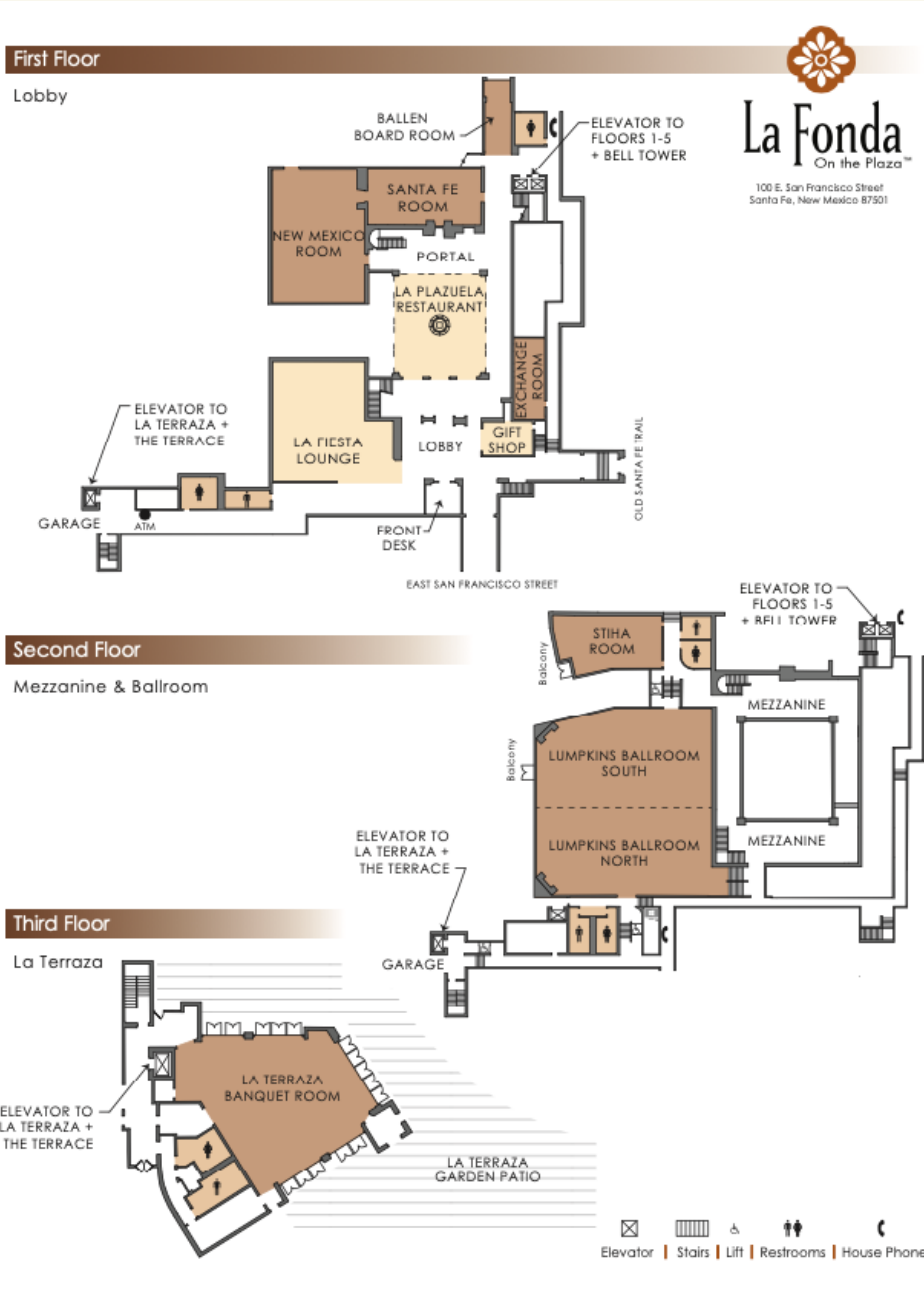

RESTORE & RECONNECT
IN THE LAND OF ENCHANTMENT

SANTA FE, NEW MEXICO
LA FONDA ON THE PLAZA

APRIL 2-4, 2024



NOTES

Dear Esteemed Guests, Colleagues, and Partners,

Welcome to beautiful Santa Fe, New Mexico and the 2024 Region VI Community Action Association Conference. This gathering serves as a shining example of collaboration, innovation, and empowerment as we come together to address the pressing challenges and opportunities that our communities face. As stewards of positive change, we recognize the pivotal role that Community Action Agencies play in fostering self-sufficiency, social justice, and inclusive growth. Your commitment to creating meaningful impact in the lives of those we serve is commendable, and this conference serves as a platform to share insights, strategies, and best practices that will shape the future of our region.

Conference Theme: "Restore & Reconnect in the Land of Enchantment"

This year's theme summarizes our vision to come together once again and continue our work towards addressing and alleviating poverty. Together, Let's Make a Difference.

The Region VI Community Action Association Conference is more than just an event; it is a testament to our shared commitment to achieve our Mission of "Helping People. Changing Lives."

What to Expect:

Inspiring Keynote Speakers: Experts and leaders will share their insights on current trends, challenges, and innovative solutions in the community action landscape.

Interactive Workshops: Participate in hands-on workshops designed to equip you with practical skills, strategies, and tools to enhance your effectiveness in community empowerment.

Networking Opportunities: Connect with peers, partners, and others to foster collaborations that will amplify the impact of our collective efforts.

Showcasing Success Stories: Learn from successful initiatives and projects implemented by Community Action Agencies within our region. These success stories will serve as inspiration and valuable lessons for all attendees.

Thank you for being a part of this transformative experience. We look forward to learning, sharing, and growing together at the Region VI Community Action Association Conference!

Warm regards,

Becky Porter
Region VI President

SCHEDULE

APRIL 2, 2024 TUESDAY

8:00am - 5:00pm

Registration

Mezzanine

8:30 - 11:30am

Board of Directors' Meeting

Santa Fe Room (invitation only)

12:00 - 2:00pm

Opening Luncheon

Lumpkins Ballroom

Welcome to New Mexico

Dawn Z. Hommer, Vice President, Region VI

Noelia McNew, Executive Director, NMACP

Conference Overview

Becky Porter, President, Region VI

Greetings

Senator Jerry Ortiz y Pino

Michele Suina, PhD, Program Director, Comprehensive Approaches to American Indian Health & Wellness

Legislative Update with David Bradley, NCAF

Introduction by **Bill Powell**, NCAF Rep, Region VI

2:00 - 2:30pm - Break

2:30 - 4:10pm

State Presentations

2:30 New Mexico

2:50 Louisiana

3:10 Arkansas

3:30 Oklahoma

3:50 Texas

Thank you to our sponsor!



HELPNM

*Working together to help
New Mexico's most
vulnerable citizens*



Chicanos Por La Causa (CPLC) formed in 1969 to fight discrimination against the Mexican American community. Inspired by Dolores Huerta and Cesar Chavez, we advocated for equity in education, politics, and labor conditions. Today, CPLC provides services to people of all backgrounds while honoring our Mexican American roots. With offices in Arizona, California, Nevada, New Mexico, and Texas, we impact almost 1 million lives every year.

**CHICANOS
POR LA CAUSA**

HELLO, SANTA FE!

Spend some time in the original city center, from the historic Plaza to the oldest church in the United States. Downtown Santa Fe is full of stories and classic architecture featuring eclectic restaurants, galleries, boutiques, bookstores, and museums. Walk along the Santa Fe River, peek in on the unique New Mexico State Capitol—the only circular state capitol building in the US -- and take a tour of the New Mexico Capitol Art Collection.



GEORGIA O'KEEFFE MUSEUM

Open daily 10 AM – 5 PM
217 JOHNSON ST / www.okeeffemuseum.org

Conference attendees enjoy 50% off!
(present name badge for discount)



NEW MEXICO HISTORY MUSEUM

Multi-faceted views on New Mexico's complex history.
Open daily 10 AM – 5 PM
113 LINCOLN AVE / www.nmhistorymuseum.org



SAN MIGUEL CHAPEL

The oldest church in the continental U.S.
Open Mon-Sat 11AM – 3PM
401 OLD SANTA FE TRAIL / www.sanmiguelchapel.org



INSTITUTE OF AMERICAN INDIAN ARTS

The only museum in the U.S. for exhibiting and collecting the work of contemporary Native artists.
See website for hours
108 CATHEDRAL PL / www.IAIA.edu



MUSEUM OF INTERNATIONAL FOLK ART

Largest collection of folk art in the world representing many diverse cultures.
Open Tues-Sun 10 AM – 5 PM
706 CAMINO LEJO / www.internationalfolkart.org

MEOW WOLF

Featuring House of Eternal Return, an immersive permanent art installation and astonishing form of storytelling.
See website for hours
1352 RUFINA CIR / www.meowwolf.com

4:15 - 4:45pm

Election of Board Officers

Lumpkins Ballroom

5:00 - 6:30pm

Re/Connect Reception

Network with peers in the La Terraza Banquet Room (3rd Floor) while enjoying Street Tacos featuring pork carnitas or red snapper and plenty of condiments! Cash bar.

APRIL 3, 2024 WEDNESDAY

8:00 - 9:00am

Breakfast Buffet

Lumpkins Ballroom

9:00 - 10:00am

Community Action Update

Denise Harlow, CEO

National Community Action Partnership

10:00 - 10:30am Break

10:15am - 12:15pm

Roundtable Discussions

Please choose two sessions (see insert for details).

Session 1: 10:30-11:15am

Break 11:15 - 11:30am

Session 2: 11:30-12:15

12:15 - 2:00pm

Lunch on your own

2:00 - 3:30pm

Restore: Well-Being Workshops (see insert for details)

Facilitated by Lisa Brewer, PCC

2:00 - 2:15 Group Meet, Lumpkins Ballroom

2:15 - 3:00 Chosen Activities

3:00 - 3:30 Group Reconnect, Lumpkins Ballroom

3:30 - 4:00pm Break

4:00 - 5:00pm

Connecting With Your Community

Facilitated by Lisa Brewer, PCC

Lumpkins Ballroom

APRIL 4, 2024 THURSDAY

8:00 - 10:00am

Breakfast & Closing Session

Lumpkins Ballroom

State of the Association

Becky Porter, Region VI Board Chair

Thank you to our sponsor!



New Mexico Association of Community Partners welcomes you!



SPEAKERS AND PRESENTERS

David Bradley

David Bradley was recruited by national leaders of the Community Action movement in 1981 to defend the Community Action Program from complete elimination. With Bob Cord of ABCD in Boston, MA, and Charles Braithwait of West Central Missouri Community Action Agency in Appleton City, MO, Bradley founded the National Community Action Foundation (NCAF) to preserve and create opportunities for the Community Action Agency network. His first act was to design the Community Services Block Grant (CSBG), which preserved the federal-to-local funding pipeline through Community Action Agencies for the purpose of mitigating the causes and conditions of poverty. He has succeeded in growing the federal investment in CSBG for more than four decades and has expanded the ability of CAAs to address the complex and changing needs of low-income people and communities. David's legislative activities also include Weatherization Assistance, the Low Income Home Energy Assistance Program and other programs that address local causes and conditions of poverty.

Lisa Brewer, PCC

Lisa Brewer Coaching

Lisa Brewer coaches goal-oriented professionals and organizations to strengthen their leadership, teamwork, career advancement, and wellbeing. Frequent coaching topics include communication, influence, strategic planning, relationship building, productivity, delegation, self-talk, habit formation, and work-life balance. She holds an MBA from Ross School of Business, a BS in Psychology, and four coaching certifications. Her professional experience includes Fortune 500 companies, law and IT firms, and several non-profits. She was the Executive Director Nurture, a nonprofit that provided wellness classes to low-income families and elementary students, and has taught workshops on habit formation, self-care, productivity, communication, and career fulfillment for several organizations.

Denise Harlow

Denise Harlow, CCAP, is the Chief Executive Officer of the National Community Action Partnership, a national hub that links the nation's 1,000+ Community Action Agencies to each other and to federal, state, and local leaders looking to connect Americans to greater opportunity. She was appointed the Partnership's CEO in 2014 after serving as Senior Director of Training and Technical Assistance and Interim Chief Operating Officer. Working with Community Action Network Partners, Denise was instrumental in the design and deployment of network-wide Organizational Standards and was a leader in the recent update to the Community Action performance management framework. She started her Community Action career as a social worker with the Schenectady Community Action Program. She holds a Master's Degree in Social Work from the University at Albany and a Bachelor's Degree in Social Work from Valparaiso University.

Senator Jerry Ortiz y Pino

Senator Ortiz y Pino is a 12th generation New Mexican whose career has been dedicated to leadership in health and human services and higher education in both private and public sectors. He served as the Director of Family and Community Services for the City of Albuquerque, and Division Director for New Mexico Social Services. He was elected to State Senate District 12 in 2004, and retired in 2024 after serving five four-year terms. Legislative areas of focus were health, behavioral health, and children's services. He also sponsored major legislation pertaining to the Working Families Tax Credit, Cannabis legalization (Medical and Recreational), Home visitation Programs, Guardianship reform, Charter School supports and prison reform.

Michelle Suina, PH.D.

Michele Suina, PhD, is a tribal member of Cochiti Pueblo. She currently is a Program Director at the Albuquerque Area Southwest Tribal Epidemiology Center for the Good Health and Wellness in Indian Country Program. Michele is a health educator and chose this career pathway to contribute to the vitality of Native Americans and to help transform western based public health approaches so tribes can realize their own self-defined health goals. In 2015, Michele graduated from Arizona State University School of Social Transformation with the first Pueblo PhD Justice Studies Cohort. Her scholarly interests include research ethics and health education approaches grounded in Indigenous Knowledge Systems.